

Panel Cutout

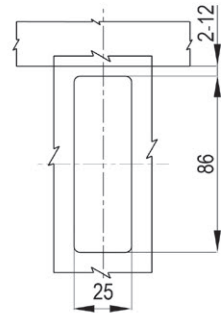

Panel Cutout

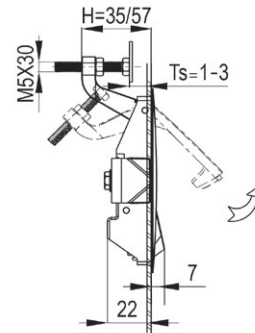
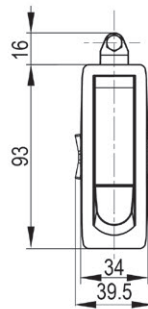
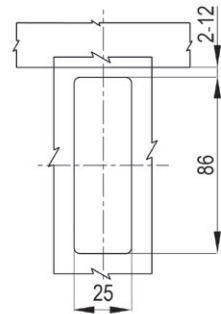
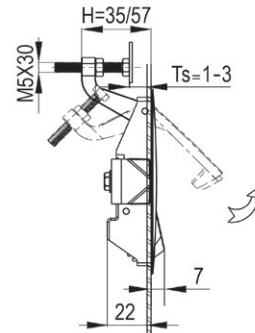
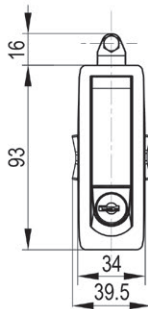

Panel Cutout

Zinc die handle, housing and trigger (black powder coated or bright chrome). Mild steel zinc plated screw and fixing components. Rubber seal gasket.

Grip Range	1-24		23-46	
	Short Arm		Longer Arm	
Trigger Style	Black Powder Coated	Bright Chrome	Black Powder Coated	Bright Chrome
Non-Locking Raised Trigger	1242-124-10	1242-124-30	1242-146-10	1242-146-30
Non-Locking Flush Trigger	1242-224-10	1242-224-30	1242-246-10	1242-246-30
Key Locking 751	1242-324-10	1242-324-30	1242-346-10	1242-346-30
Tooling Secured	1242-524-10	1242-524-30	1242-546-10	1242-546-30
Key Locking With Shutter	1242-624-10	1242-624-30	1242-646-10	1242-646-30
Hexagon Female 4.5mm	1242-724-10	1242-724-30	1242-746-10	1242-746-30
8.5mm Square Railway Standard	1242-824-10	1242-824-30	1242-846-10	1242-846-30

Remark 1. Keyed KEY333 on request. 2. Key different on request