

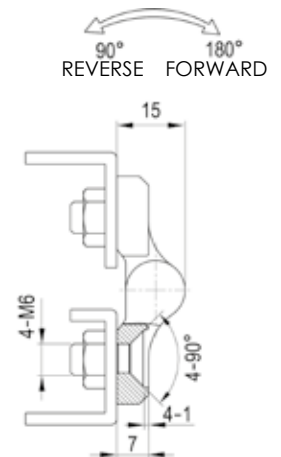

Countersunk Screw M6

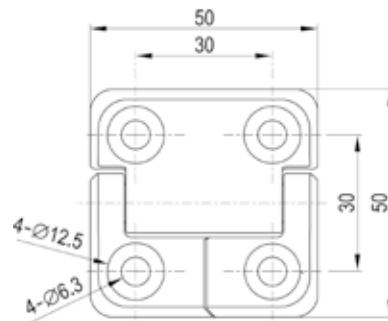

With Threaded Studs M6

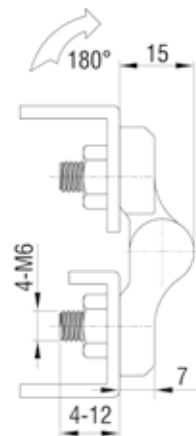
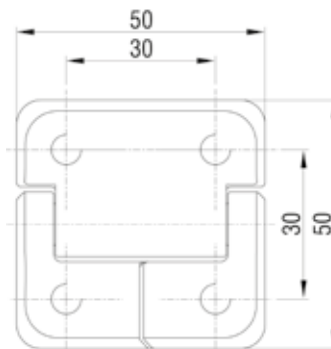

Zinc screw-on torque hinge, stainless steel pin. Asymmetric N.m.

| Black Textured Powder Coated | | |
|------------------------------|----------------------|------------------------|
| N.m. | Countersunk Screw M6 | With Threaded Studs M6 |
| Free Operating | 2136-5000-20 | 2136-5100-20 |
| 1.8 | 2136-5018-20 | 2136-5118-20 |
| 2.3 | 2136-5023-20 | 2136-5123-20 |
| 3.4 | 2136-5034-20 | 2136-5134-20 |

| Black Textured Powder Coated | | | |
|------------------------------|--------------------|----------------------|------------------------|
| Forward Torque N.m | Reverse Torque N.m | Countersunk Screw M6 | With Threaded Studs M6 |
| 2.3 | 1.4 | 2136-5023F-20 | 2136-5123F-20 |
| 3.4 | 2.0 | 2136-5034F-20 | 2136-5134F-20 |
| 4.5 | 2.7 | 2136-5045F-20 | 2136-5145F-20 |
| 1.4 | 2.3 | 2136-5014R-20 | 2136-5114R-20 |
| 2.0 | 3.4 | 2136-5020R-20 | 2136-5120R-20 |
| 2.7 | 4.5 | 2136-5027R-20 | 2136-5127R-20 |

CYCLE LIFE: 1. Within 25,000 cycles static torque stay. 2. Within ±20% of torque specification.