

MODEL/STROKE	SPRING FORCE (daN)		L		GAS VOL. (L)	WEIGHT (KG)
	INITIAL	MAXIMUM	MIN	L		
EX0170-007	170	280	37	44	0.002	0.06
EX0170-010		280	40	50	0.002	0.06
EX0170-013		280	43	56	0.003	0.07
EX0170-015		280	45	60	0.004	0.07
EX0170-019		280	49	68	0.005	0.07
EX0170-025		280	55	80	0.006	0.08
EX0170-032		280	62	94	0.008	0.09
EX0170-038		280	68	106	0.009	0.09
EX0170-050		280	80	130	0.012	0.10
EX0170-063		280	93	156	0.015	0.12
EX0170-075		280	110	185	0.018	0.13
EX0170-080		280	115	195	0.019	0.14
EX0170-100		280	135	235	0.024	0.16
EX0170-125		280	160	285	0.030	0.19

SPECIAL STROKE SIZES AVAILABLE UPON REQUEST

ORDERING EXAMPLE: **EX0170-007**

USE ONLY NITROGEN

MAX. PRESSURE: 180 BAR    MIN. PRESSURE: 20 BAR    MAX. PISTON VELOCITY: 1.6M/SEC



**SRS**  
SECONDARY ROD SCRAPER

PREVENT DUST, DIRT AND OIL FROM REDUCING THE LIFE OF YOUR GAS SPRINGS

CODE: SRS-11

**GAS SPRING FORCE CALCULATOR**

[www.metrol.com/gas-spring-force-calculator](http://www.metrol.com/gas-spring-force-calculator)

**MOUNTING EXAMPLES**

(all dimensions are mm, unless otherwise stated) for other possible mounting options see pages 84 - 88

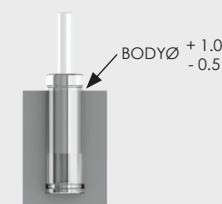

Drop-in Pocket



Front Flange  
Ø19 FF



M6 Tapped Hole  
Only for strokes up to 25mm

Please note: gas springs should always be positively retained where possible. How to order: Spring Type x Stroke + Mounting Type ie: EX0170 X 007 + FF